



EN Installation and User Manual

Important information: To prevent damage and improper use, please keep this installation and user manual readily accessible. Please read it carefully before installing or using the shower. Our information sheets and printed materials are provided for guidance based on our best knowledge. The content is provided without legal obligation. In all other respects, our General Terms and Conditions apply.

SOLAR SHOWER PORTABLE 14 L

Description:

The garden solar shower is designed as a compact body in the form of a hollow PP pole serving as a warm water reservoir and a solar collector at the same time. Water supply fittings and pipes are installed inside of the pole (shower) body. The control lever, shower head and holder are placed outside of the shower body. The lower part (foot) of the pole is provided with a base providing it with sufficient stability without any need of anchoring, if handled in an ordinary way. The water filling fitting is found in the lower rear part of the shower body.

Use:

The shower is intended for use in private facilities such as gardens, camping places, garden pool areas or private tennis courts. It should be used for individual showering of persons and is intended neither for use by general public nor for any commercial application.

Warning Symbols in the Directions:

Safety instructions given in these Directions are emphasized with generally used hazard symbols and shall be unconditionally observed.



A hazard symbol complying with the ČSN ISO 3864 standard.

Safety Instructions:

Any user of this product shall strictly observe all safety instructions given in the Directions without any exception!

These Directions for use include basic instructions that shall be observed while installing and operating the solar shower. Any failure to observe the safety instructions not only may pose threat to human health but it may put at risk also the ambient environment and the equipment itself.

The garden solar shower is intended for showering persons outdoors with water only. In the event the shower is used for any other purpose than intended, or it has been modified in a way not approved by the manufacturer, the manufacturer shall not assume liability or responsibility for any loss or damage and all warranty claims shall become void at the same time.



Due to hygienic reasons, before or after a longer period in which the equipment has not been used, drain water from the solar shower, see „**Maintenance and Wintering**“. If the water is not regularly changed in the solar shower, and stays there for a longer period, microorganisms may propagate there and cause health problems.

The solar shower shall not be used by persons not acquainted with the operation thereof within the scope of these Directions.



Taking account of the temperature of water stored (and heated) in the shower body (it can be as high as 60-70 °C) it is recommended first to turn the valve lever to the right a little and open the flow of cold water by deflecting the lever from the shower body. Only then adjust the flow temperature by turning the lever to the left. This procedure will protect you from undesirable contact with hot water.



Be cautious when handling the shower or staying in its vicinity.



As the shower may not be anchored firmly to the ground, there is a risk of toppling and fall, if not handled with due care. This could cause damage to the shower or other property and, moreover, there is a risk of personal injury.

Instructions for Assembly:

In assembling the shower base proceed, please, according to **FIGURE 1**. Place the solar shower on a place with ample sunlight and within the reach of a water supply line. The shower need not be firmly anchored to the ground as the base provides it with sufficient stability. Nevertheless, if you decide to anchor the shower to the surface, proceed, please, in compliance with **FIGURE 2** and attach it either to a firm support (such as a heavy concrete slab) using dowel pins and screws (ø 8 mm) or, possibly, to the ground using special (long) spikes. Screw the hose with the shower head to the neck of shower fitting at the rear upper part of the shower body. A hose quick coupler (included in the delivery) may be used for easy connection of the unit to the water supply network via the neck of shower fitting (1/2") found at the rear lower part of the shower body. The external water supply line should be attached to the shower body before opening the supply valve.

The standard inlet fitting of the shower shall be neither removed nor modified. One shall take into account the inlet fitting and the shower body are connected using plastic parts. That is why no excessive force should be applied when connecting the shower to the water supply line or domestic pumping unit. Tighten the connections using only the force of your hands. Do not use tools for tightening. Any connections shall be made

EN Installation and User Manual

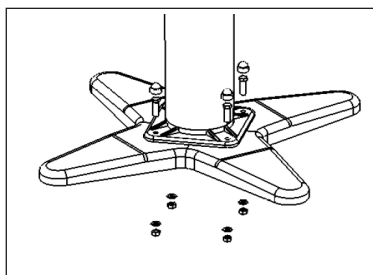

Figure 1
Assembling
the stand

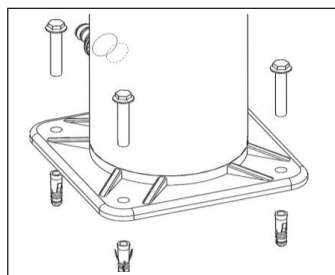

Figure 2
Anchoring
the shower

using standardised, approved and undamaged water fittings only.

After connecting the solar shower to the water source fill the shower body (reservoir) completely with water at simultaneous venting. Open the supply valve and the shower system (turning the valve lever to the position of OPEN warm water flow) and let it fully open until water begins to flow continuously from the shower head. Then press the control lever to the CLOSED position. Now the solar shower is ready for use. Finish the assembly by inspecting all connections for possible leaks.

Maintenance and Wintering:

The garden solar shower does not require any special maintenance. Keep the solar shower clean. After the end of summer season disconnect the solar shower completely from water supply and drain water from the system via the neck of shower head hose by tipping the unit over with the lever valve open, i. e. set in the position between "warm" and "cold" water. Due to its design there will remain a residual volume of water (0.3 l max.) in the system. This residue will not cause damage to the shower. For the period of storage ensure that the lever valve and shower head are dry. Pack them in an airtight wrapping to be protected from moisture. Out of the season store the product at a dry place protected from frost.

Transport and Storage:

In order to protect the product from damage and loss of its particular parts the original delivery may be unpacked not earlier than immediately before assembly of the solar shower.

Solar Shower Basic Parameters:

Solar shower reservoir volume: 14 litres

Operating pressure of your water supply: 2-3 bar

Body height: 1450 mm (without shower head)

Product net weight: 5.4 kg

Support anchoring plate: 4 holes of \varnothing 9 mm, with the pitch of 130x130 mm

Content of Delivery:

- Shower body
- Shower base
- Shower head hose
- Shower head
- Bolts, screws and nuts
- Inlet hose quick coupler
- Directions for Assembly and Use

Description of Assembly:

- 1 – Shower body
- 2 – Shower base
- 3 – Lever operated mixing valve
- 4 – Shower head hose
- 5 – Shower head holder
- 6 – Shower head
- 7 – Screws for fixing the base

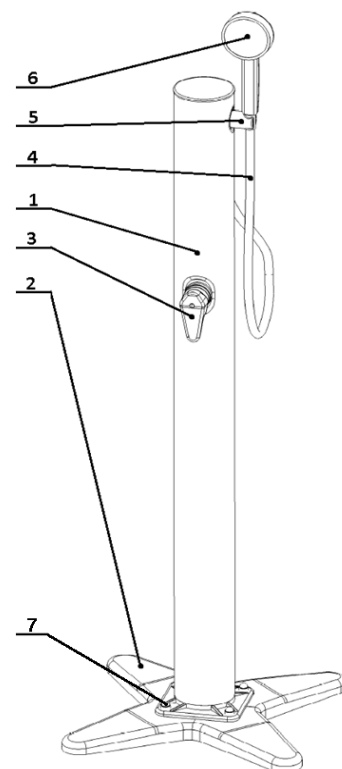

Conditions of Warranty:

Provided that all and any conditions of use have been observed as required by the distributor, the manufacturer shall grant the 24 months "warranty" for this product. The warranty shall not apply to and the manufacturer shall accept no liability for any defect and/or damage caused by incorrect product assembly, use or wintering. The service and spare parts the manufacturer shall provide through the network of its dealers.